



803

Chemical Goose

Lawn & Garden / Bleach / Pesticide
Gasoline / Detergent / Clean Agents

Instruction Manual

INDEX

Index	1
Specifications	2
Unpacking	3
Important Product Note	4
Warnings	5
Protection	6
Operation	7
Replacement Parts SKU numbers	8
Return Instructions	9
Warranty Info	10

803 CHEMICAL GOOSE SPECIFICATIONS

Target Market	<p>General Applications To Spray Xylene, Bleach, Cyclohexane, Gasoline (with good results). Hydrofluoric Acid, Sulphuric Acid, Degreaser are acceptable (with fair results).</p> <p>Spraying Acetone and Vinegar are prohibited.</p> <p>Spraying any chemical other than the allowed types may damage the product and can pose a hazard to the user.</p> <p>Contact us if you have any question or concern: info@sprayers-plus.com</p>
Tank Capacity - Litres / oz	1.44 / 48.7
Spraying Performance	<ul style="list-style-type: none"> • High output piston for up to 25 feet of horizontal reach • Fine mist performance for even distribution
Dry Weight - Kg / oz	0.26 / 9.2
Product Dimension - cm / inch	20.9 x 8.7 x 26.5 / 8.23 x 3.43 x 10.43
Package Dimension - cm / inch	22.0 x 9.5 x 28.0 / 8.67 x 3.74 x 11.02
Seals & O-rings	Special formulated seals withstand a wider range of chemicals
Spring	Marine-grade 316 stainless steel spring for superior chemical resistance
Includes adjustable stream / mist nozzle	90° & 110° fan tips
Warranty	1 Year (For General Residential Usage)

UNPACKING AND ASSEMBLY

803 CHEMICAL GOOSE (Spray Head + Bottle)

2 Pieces Fan Nozzle Set

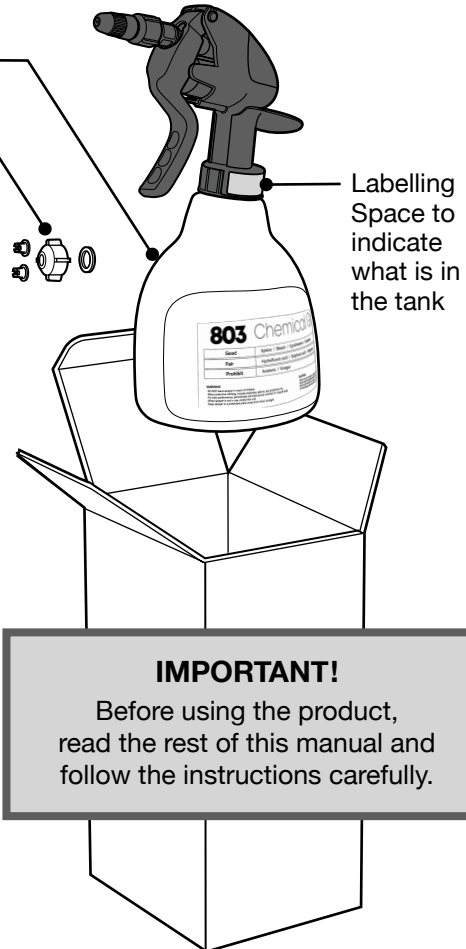
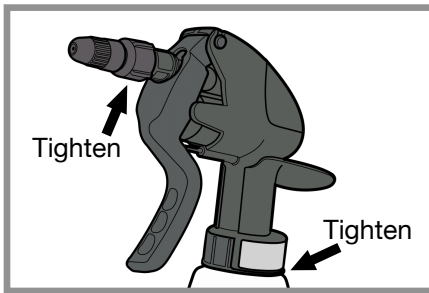

CAUTION: Make sure the seals for the nozzle and the bottle are tightened (see the diagram above).

If any of them is not tightened properly, air (and fluid) may leak out through those locations.

Further tightening of those parts can stop such leakage.

NOTE: You may find a very small amount of residual water in the tank of a brand new unit, this is from the quality and performance testing in the factory. This is normal.

IMPORTANT PRODUCT NOTE

SprayersPlus produces top quality products meeting the highest standards in the market.

To ensure your safety, optimize the user experience and maximize the life span of this product, it is of utmost importance to follow the product instructions, as well as the DOs and DON'Ts outlined in the operation and maintenance procedures of this manual.

803 CHEMICAL GOOSE is engineered to spray Lawn & Garden Chemicals, Bleach, Pesticide, Gasoline, Detergent, Cleaning Agent.

Spraying any chemical other than these may damage the product and pose a hazard to the user.

If you have any question about chemical compatibility, contact us at info@sprayers-plus.com

Please read this manual thoroughly and follow carefully.

SAFETY GUIDELINES - DEFINITIONS

It is important for you to read and understand this manual.

The information contains relates to protecting YOUR SAFETY and PREVENTING PROBLEMS.

The symbols below are used to help you recognize this information.



WARNING!

Indicates a potentially hazardous situation which, if not avoided, could result in death or serious injury.



CAUTION!

Indicates a potentially hazardous situation which, if not avoided, may result in minor or moderate injury.

Contact us if you have any question or concern:
info@sprayers-plus.com



WARNING!

IMPROPER USE OR FAILURE TO FOLLOW INSTRUCTIONS CAN RESULT IN EXPLOSION OR LEAKAGE CAUSING SERIOUS EYE OR OTHER INJURIES.

FOR THE SAFE USE OF THIS SPRAYER, YOU MUST READ AND FOLLOW ALL INSTRUCTIONS.

- Do not attempt to modify this sprayer. Replace parts only with manufacturer's original parts.
- Flammable, caustic, chlorine, bleach or other corrosive solutions must not be used unless you are using the appropriate type of sprayer engineered to handle the specific chemical. Always read and follow manufacturer's instructions before using this sprayer because some chemicals may be incompatible and hazardous when used with this sprayer.
- Do not store or leave solution in the tank after use. Do not leave a sprayer in the hot sun. Heat can cause pressure to build up, resulting in possible explosion.
- To reduce the risk of injury, always wear proper protective clothing and gears when filling, using and/or cleaning the sprayer. Eye protection should meet the requirements of ANSI Z87.1.
- Wear appropriate mask or respirator when filling, using and cleaning the sprayer according to the recommendation by the manufacturer of the chemical or solution you are using.
- Wear sturdy rubber-soled shoes or shoes with anti-slip protection to help protect you against falling when filling, using and/or cleaning the sprayer.
- Do not wear loose clothing, scarves, neck chains, hair longer than shoulder length when filling, using and/or cleaning the sprayer.
- In case of personal contamination: remove contaminated clothing, remain upright, do not consume liquids or cause vomiting, and get professional help immediately.
- Refrain from operating the sprayer if you are tired, ill, or upset, or if you are under the influence of alcohol, drugs or medication.
- Never let a child under age 13 use this product.
- Do not eat, drink, or smoke while spraying, Wash your hands thoroughly after spraying.

PROTECTION

WHEN SPRAYING CORROSIVE / HAZARDOUS LIQUIDS

803 CHEMICAL GOOSE is not manufactured for industrial usage.

In case you choose to spray corrosive / hazardous liquids,

WEAR APPROPRIATE PROTECTIVE GEAR!

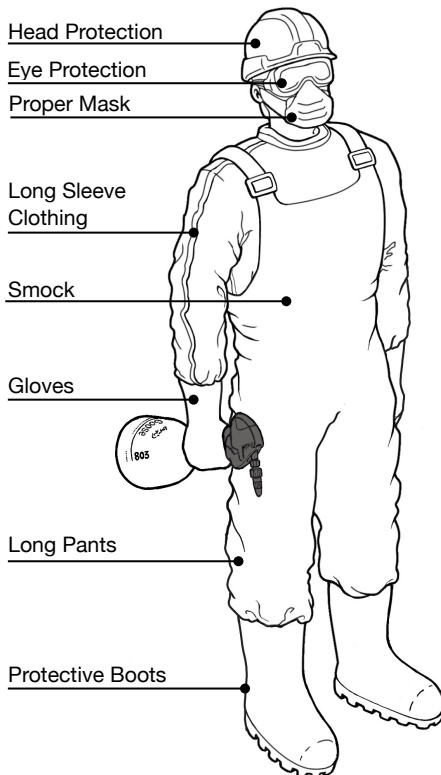

Follow Occupational Health and Safety regulation.

Wearing protective clothing and equipment when handling chemicals is obligatory.

⚠ WARNING:

Use the correct dose and volume of chemical according to the product label.

⚠ WARNING:

Do not spray near springs, lakes, rivers and people who are not using PPE.

⚠ WARNING:

In case of an accident, remove the sprayer immediately.

OPERATION

SPRAYING & MAINTENANCE

CAUTION!

- **PRE-USE CHECK:** Before each use, check the tightness of all the connections.
- Make sure the unit is the appropriate type to spray the designated chemical.
- Do not exceed a tank solution temperature of 120°F/49°C.

PREPARATION & OPERATION

1. Follow the manufacturer's instructions to mix your chemicals in a separate container.
2. Unscrew the Spray Head and fill the Bottle. (Do not exceed the maximum level 1440 ml / 48 oz.)
3. Screw the Sprayer Head back to the Bottle, make sure it is tightened.
4. Make sure the Nozzle is tightened.
5. Simply press the trigger to spray.

NOTE: Indicate the type of chemicals that have been used in the sprayer with a label or tag.

MAINTENANCE

Cleaning of the unit is recommended every time after finishing the spraying operation:

1. Unscrew the Spray Head from the Bottle, dispose of the residue in it.
2. Fill the Bottle with clean water, screw the Spray Head back, spray towards somewhere appropriate: for certain chemicals, the intake of hazardous chemical disposal tank, if the solution is not harmful, you may consider to spray towards your driveway or inside a shower stall - run at least one bottle of water through the system to clean it thoroughly.
3. Remove residue on the nozzle (if there is any) by flushing it with water; brush with a soft brush if necessary.

Such maintenance procedures can help to maximize the life span of your 803 CHEMICAL GOOSE.

REPLACEMENT PARTS SKU NUMBER

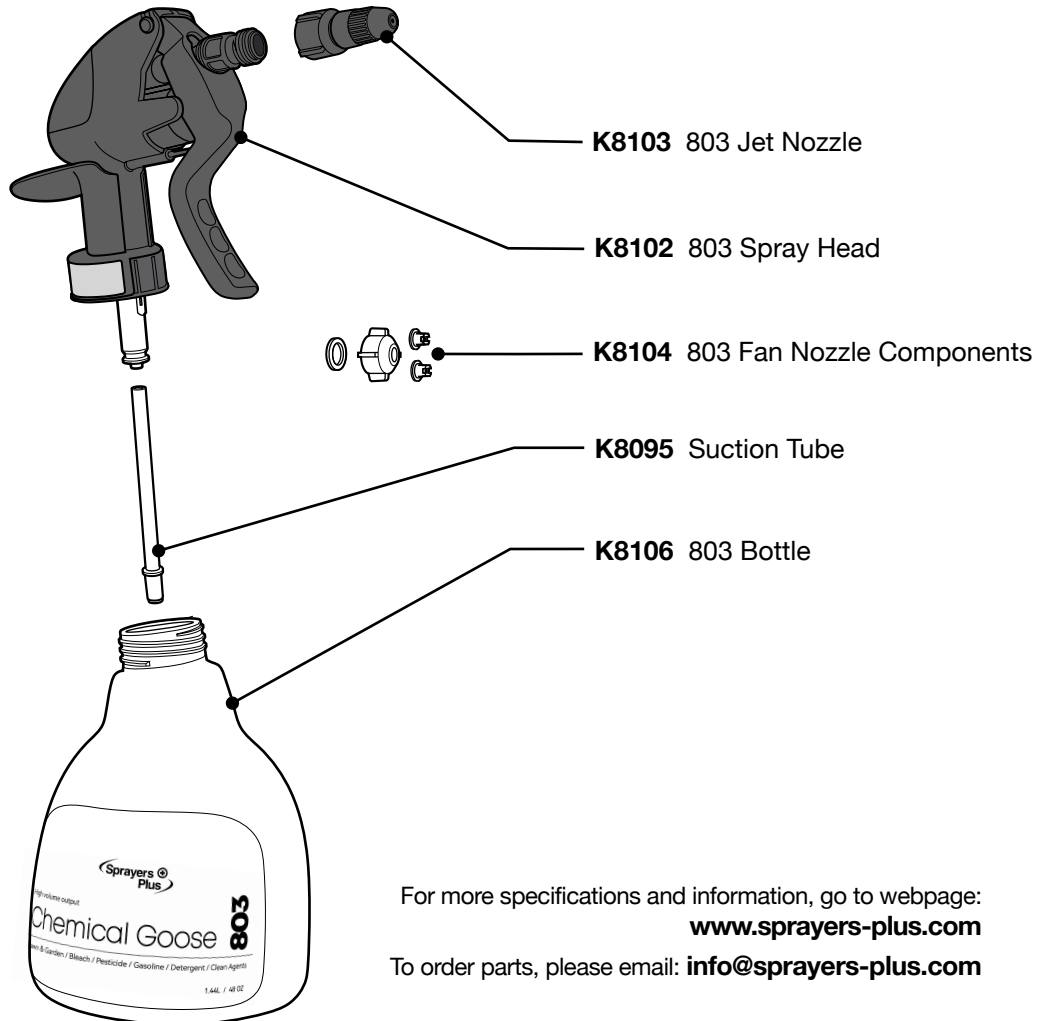

For more specifications and information, go to webpage:

www.sprayers-plus.com

To order parts, please email: info@sprayers-plus.com

RETURN INSTRUCTIONS

If it is necessary to return the sprayer for repair, always perform the following tasks before returning the sprayer:

- In an approved containment area, flush chemical residue from the pump, tank and hoses.
- Circulate fresh water through the tank and pump.
- Indicate the type of chemicals that have been in the sprayer with a label or tag.
- Include complete description of operation problem, such as how sprayer was used, symptoms of malfunction, how many working hours per day, etc.
- Since the sprayer can contain residues of toxic chemicals, these steps are necessary to protect the people who handle return shipments and to help identify issues and solutions.



WARRANTY INFORMATION

Statement of Limited Warranty

Sprayers Plus shall warrant the equipment described in this manual and shall repair or replace parts and components which, under normal operation and wear, in accordance with technical recommendations, show DEFECTS IN MATERIAL OR WORKMANSHIP, based on the following conditions.

Warranty period

1 (one) year from the date of sale to the original purchaser.

Warranty Registration

Please visit: www.sprayers-plus.com/warranty

Sprayers Plus shall honor this warranty, free of charge, if any part or component shows defect in MATERIAL OR WORKMANSHIP, after final analysis at the factory.

This Warranty shall be null and void in case of:

- Misuse of the equipment against specifications in this manual, overwork or accidents.
- Preventive / remedial maintenance performed by unauthorized people or parties.
- Use of parts and components not supplied by Sprayers Plus.
- Modification of the equipment or any characteristic of the original design.

This Warranty shall exclude

- Parts which show wear and tear due to use: spray nozzle, seals, rechargeable battery, UNLESS THEY SHOW DEFECTS IN WORKMANSHIP, ASSEMBLY OR MATERIAL.
- Damages resulting from accidents.
- Transportation or freight of the equipment, parts, and components in case such warranty is not approved.
- Transportation and travel time of technician.

web: www.sprayers-plus.com



email: info@sprayers-plus.com